



2021+ Dodge Durango Console User Guide

Description	Part Number
2021+ Dodge Durango Console	AS4.C243.201
2021+ Dodge Durango Console W/ Mousetrap	AS4.C243.202
2021+ Dodge Durango Console Box	AS4.C243.205

www.precisionmounts.com

call us at 1-888-869-7652 | info@precisionmounts.com

PARTS & HARDWARE DESCRIPTION

AS4.C243.201/202/205

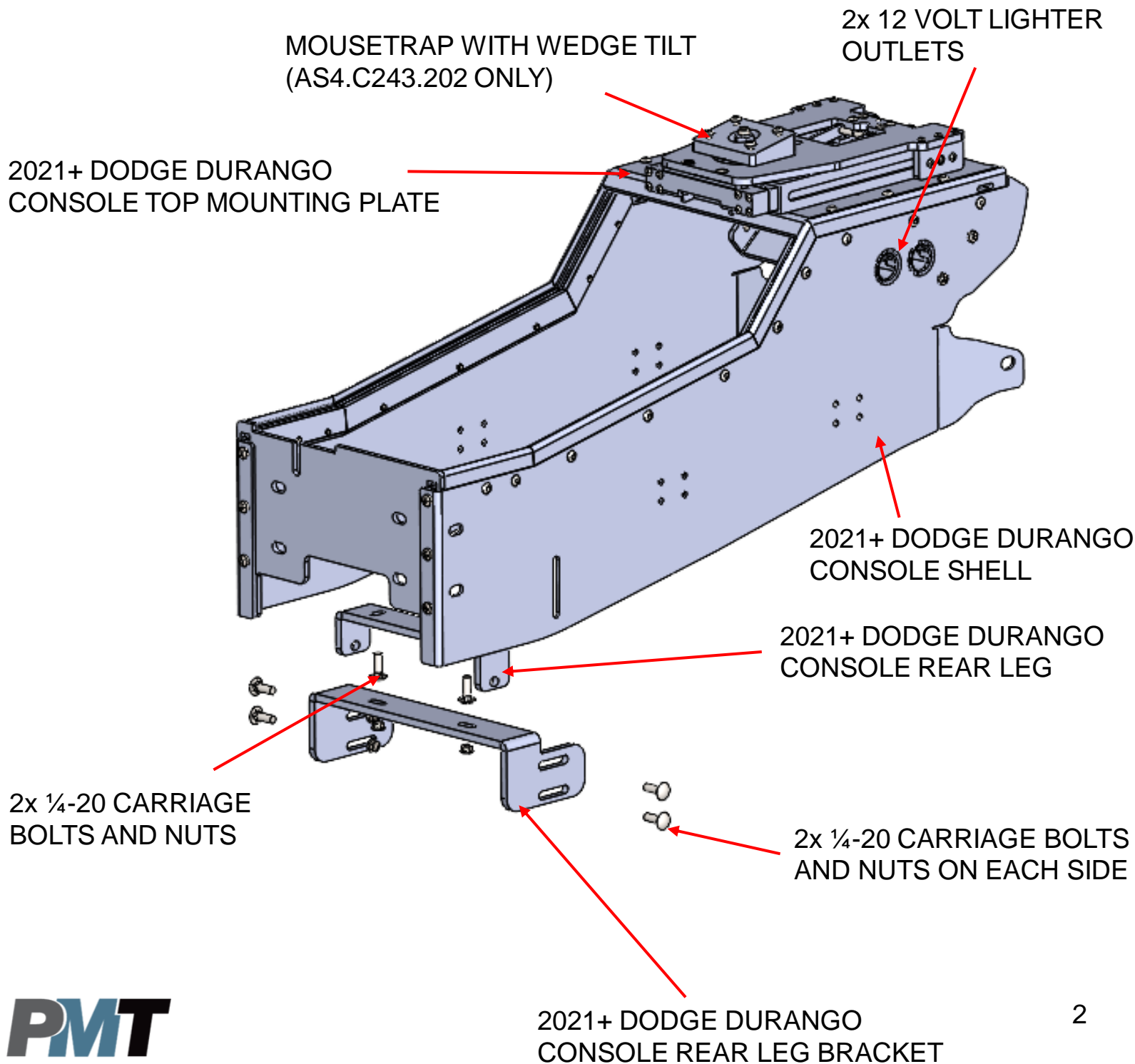

INSTALLATION INSTRUCTIONS

AS4.C243.201/202/205/
2021+ Dodge Durango Console

Tools and hardware required:

- Socket set suitable for #1/4-20 wrench
- Socket set suitable for #10-24 Hex Allen key
- Socket, 10mm

Step 1:

Remove OEM center plate with 10mm socket, 2 bolts in front under the center dash and 2 in the back (For the back bolts, it's easier to slide the seat forward to gain better access).
Keep OEM bolts as needed to install PMT console



Step 2:

With OEM center plate removed, attach PMT 2021 Dodge Durango Console rear leg to the OEM mounting location and tighten it with 10mm socket and 2x OEM bolts that was removed from step 1.

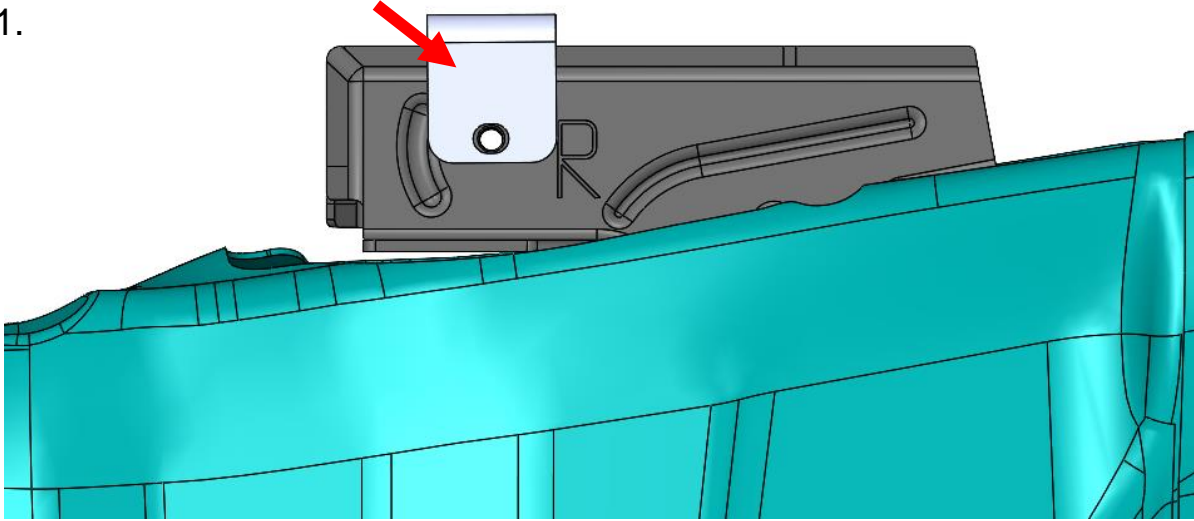

Step 3:

Put the Dodge Durango Console rear leg bracket on top, and hand tighten with the 2x ¼-20 carriage bolts & nuts.

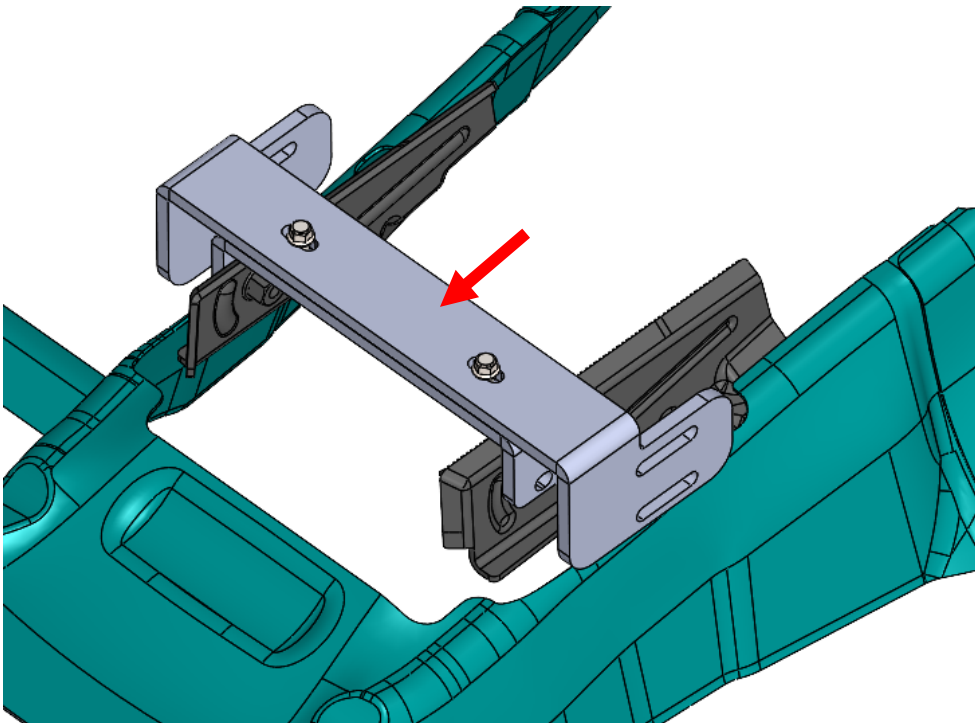

Step 4:

Place the PMT Durango Console shell between the seats and aligned with front two holes with the dash. Hand tighten it with the OEM bolts that were removed from step 1.

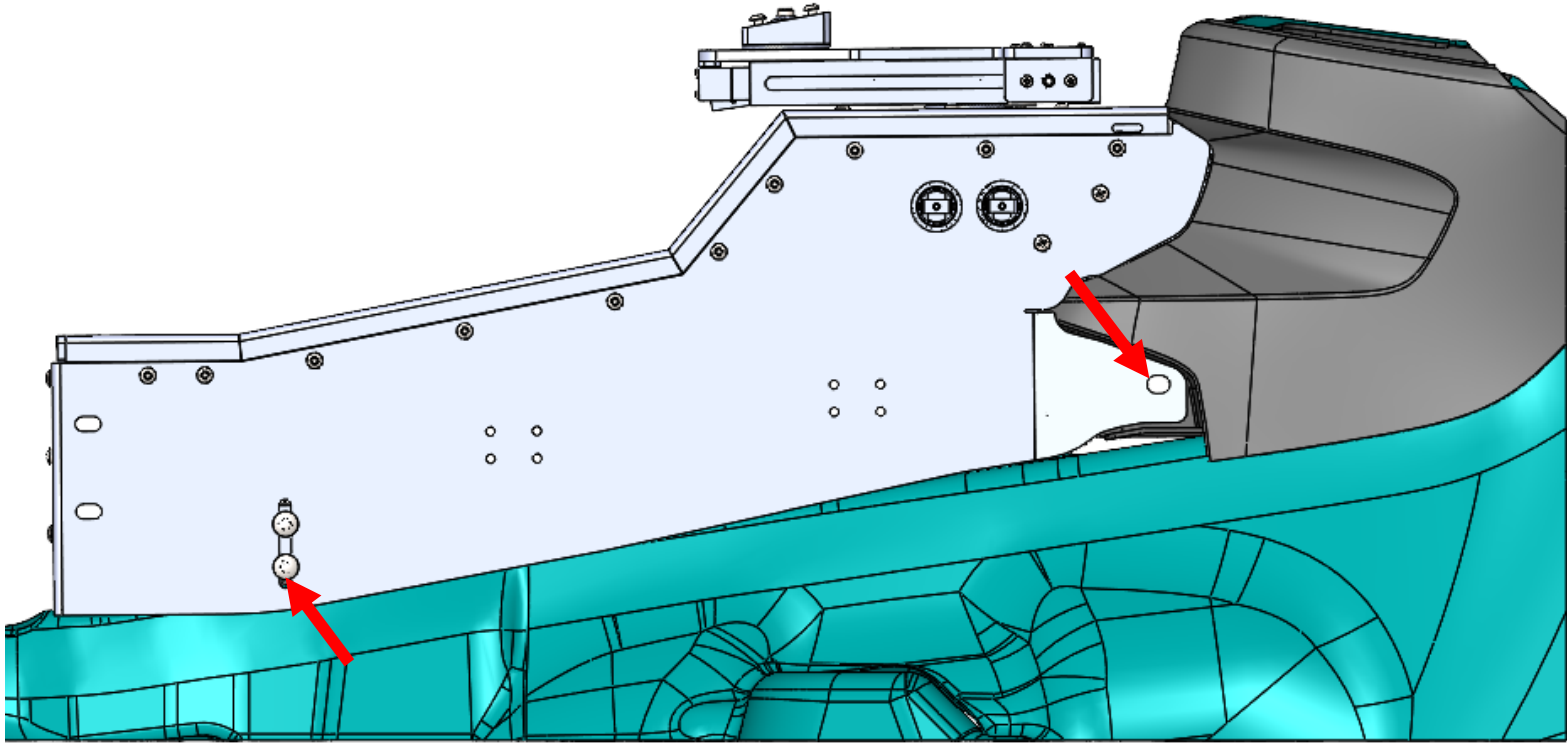

Step 5:

After the front bolts are attached, hand tighten the 2x ¼-20 carriage bolts & nuts on each side.

Step 6:

Adjust the console position, and make sure it's aligned with the dash profile.

Use the 10mm socket and #1/4 -20 wrench to tighten 2 bolts in the front, and 6 carriage bolts in the back.



Step 7:

Install Face Plates



-Install the optionally supplied: dual cupholder plate, blank filler plates, radio faces plates, and laptop mounting plates.

-The plates are secured to the console using the supplied 10-24 nuts that are slid into the console rails, and then fastened with the supplied 10-24 x 5/8" screws.



Tip:

PMT consoles use a "floating nut" style rail for attaching face plates to the console. In the consoles that have angled rails, foam inserts are used to help position the nuts for easier alignment with the face plates mounting screws. Use an Allen (hex) key to position the foam and nut where desired, then mount the face plate.

Step 8:

Take the #10-24 Allen key from the hardware bag, and place it in the glove box or other storage place in the car.

(When the vehicle needs to be towed, and the shifter can not be put into "N" position, The #10-24 Allen Key will be needed to remove the 6 screws on the Console top plate, and gain the access to the shift lock release).

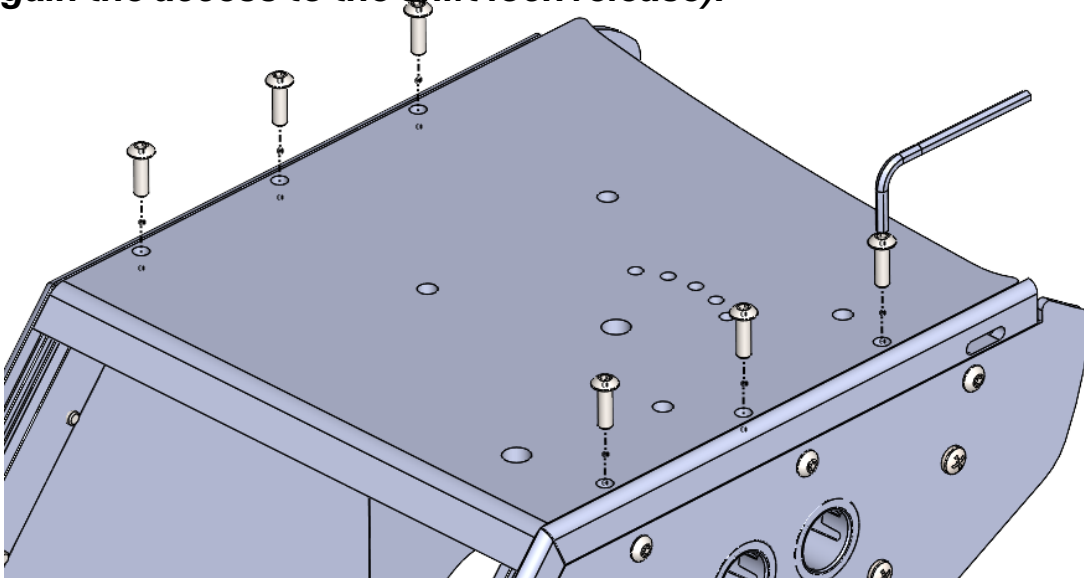

Shift Lock Release



Step 9:

Final adjustments

- Go over everything to make sure that everything is fully tightened and secure.
- Adjust positioning, and go over how the built in adjustments are used to maximize comfort, safety and functionality.

